

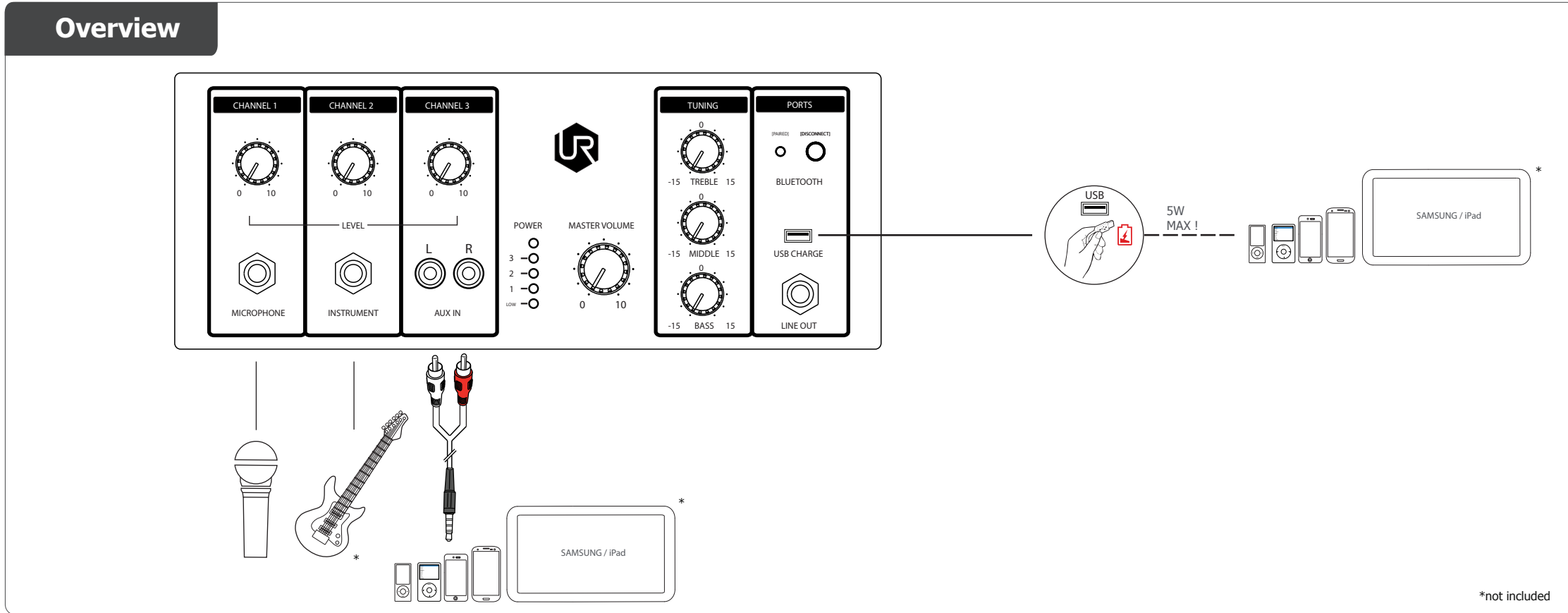

# Quick Installation Guide

Fiësta Wireless speaker

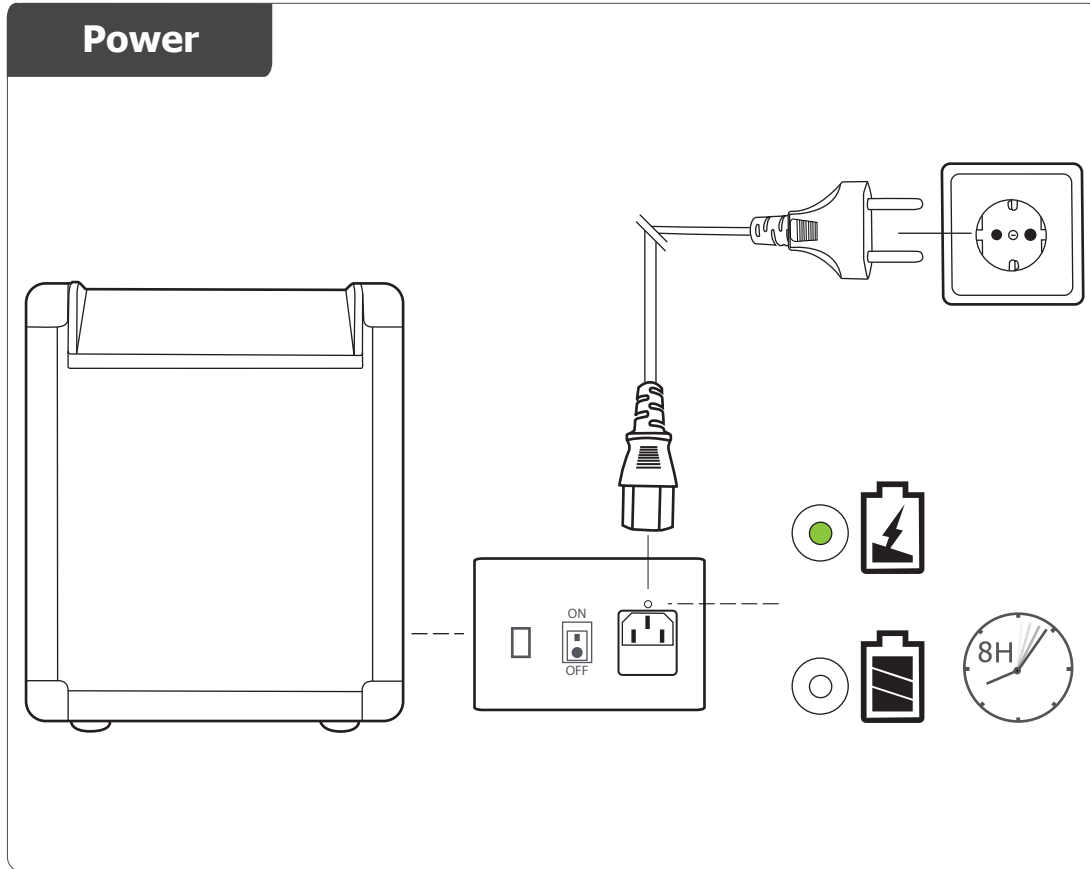

\*not included

## Wireless - Step 1

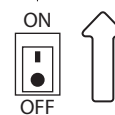
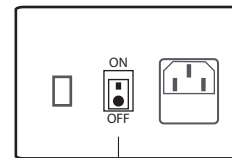

## Wireless - Step 2

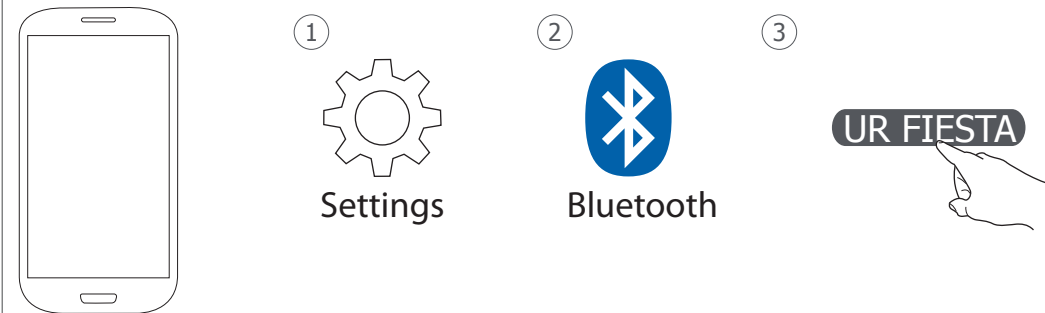

## Wireless - Troubleshooting

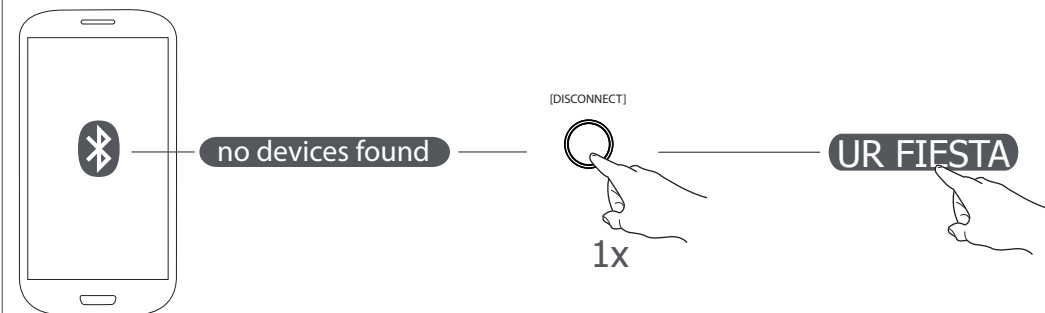

## Link speakers

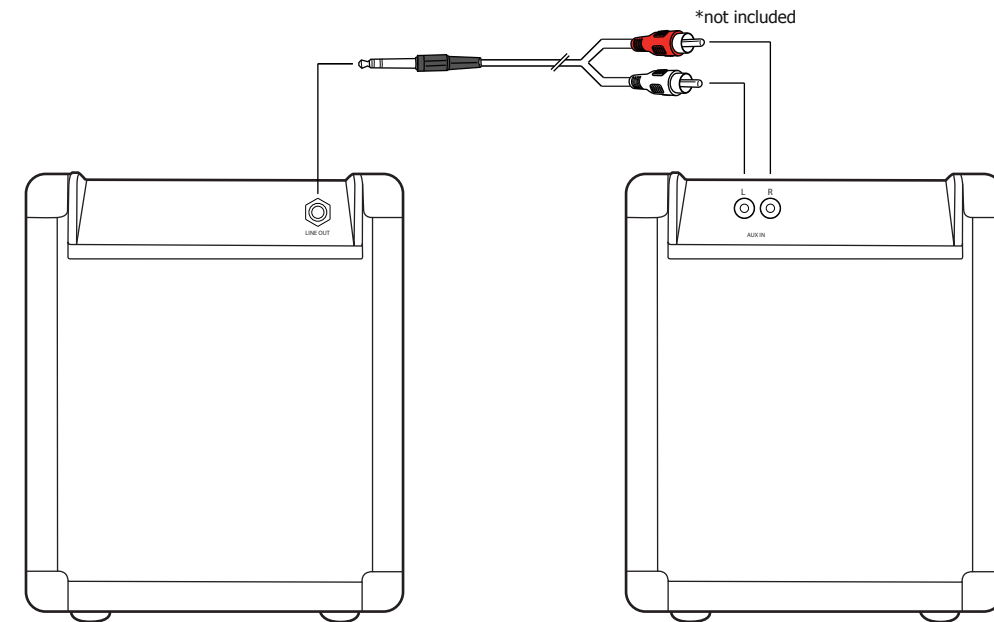

## FAQ

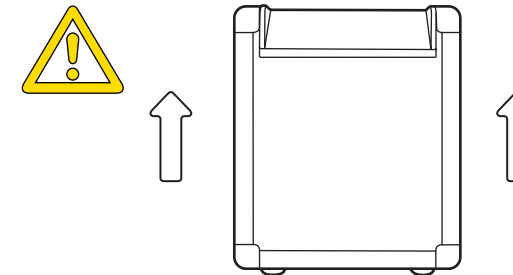

EN: Battery inside. Use and transport it in an upward position.  
DE: Akku im Inneren. In aufrechter Position bei Nutzung und Transport.  
IT : Batteria all'interno. Usare e trasportare in posizione verticale.  
ES: Baterías en el interior. Utilizar y transportar en posición vertical.  
FR: Batterie à l'intérieur. Utiliser et transporter en position vertical.  
NL: Batterij binnenin. Naar boven toe richten bij gebruik en vervoer.

Frequently asked questions

[www.urbanrevolt.com/19737/faq](http://www.urbanrevolt.com/19737/faq)

© 07-10-2013 Trust International B.V. All rights reserved.